

General Description

The MDV3604 uses advanced MagnaChip's MOSFET Technology to provide low on-state resistance.

This device is suited for Power Management and load switching applications common in Notebook Computers and Portable Battery Packs.

Features

- $V_{DS} = -30V$
- $I_D = -20A$ @ $V_{GS} = -10V$
- $R_{DS(ON)}$
 - < 10.0mΩ @ $V_{GS} = -20V$
 - < 12.1mΩ @ $V_{GS} = -10V$
 - < 18.3mΩ @ $V_{GS} = -5V$

Applications

- Load Switch
- General purpose applications
- Smart Module for Note PC Battery

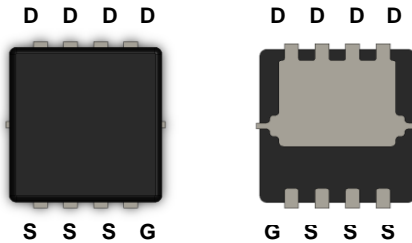

PDFN33

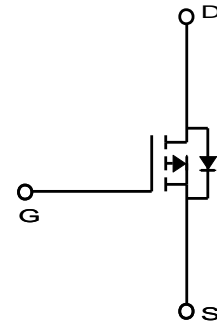

Absolute Maximum Ratings ($T_a = 25^\circ C$ unless otherwise noted)

Characteristics		Symbol	Rating	Unit
Drain-Source Voltage		V_{DSS}	-30	V
Gate-Source Voltage		V_{GSS}	± 25	V
Continuous Drain Current ⁽¹⁾	$T_C = 25^\circ C$ (Package limited)	I_D	-20	A
	$T_C = 25^\circ C$ (Silicon limited)		-36.1	
	$T_A = 25^\circ C$		-12.6 ⁽³⁾	
	$T_A = 70^\circ C$		-10.2 ⁽³⁾	
Pulsed Drain Current		I_{DM}	-32	A
Power Dissipation	$T_C = 25^\circ C$	P_D	27.7	W
	$T_A = 25^\circ C$		3.4 ⁽³⁾	
Single Pulse Avalanche Energy ⁽²⁾		E_{AS}	84.5	mJ
Junction and Storage Temperature Range		T_J, T_{stg}	-55~150	$^\circ C$

Thermal Characteristics

Characteristics	Symbol	Rating	Unit
Thermal Resistance, Junction-to-Ambient (Note 1)	$R_{\theta JA}$	36	$^\circ C/W$
Thermal Resistance, Junction-to-Case	$R_{\theta JC}$	4.5	

Ordering Information

Part Number	Temp. Range	Package	Packing	Quantity	RoHS Status
MDV3604URH	-55~150°C	PowerDFN33	Tape & Reel	5000 units	Halogen Free

Electrical Characteristics (T_a = 25°C unless otherwise noted)

Characteristics	Symbol	Test Condition	Min	Typ	Max	Unit
Static Characteristics						
Drain-Source Breakdown Voltage	BV _{DSS}	I _D = -250μA, V _{GS} = 0V	-30	-	-	V
Gate Threshold Voltage	V _{GS(th)}	V _{DS} = V _{GS} , I _D = -250μA	-1.0	-1.8	-3.0	
Drain Cut-Off Current	I _{DSS}	V _{DS} = -30V, V _{GS} = 0V	-		-1	μA
Gate Leakage Current	I _{GSS}	V _{GS} = ±25V, V _{DS} = 0V	-	-	±0.1	
Drain-Source ON Resistance	R _{DS(ON)}	V _{GS} = -20V, I _D = -12A	-	8.6	10	mΩ
		V _{GS} = -10V, I _D = -12A	-	10	12.1	
		V _{GS} = -5V, I _D = -10A		14.6	18.3	
Forward Transconductance	g _{FS}	V _{DS} = -5V, I _D = -10A		25.5	-	S
Dynamic Characteristics						
Total Gate Charge	Q _g	V _{DS} = -15V, I _D = -12A V _{GS} = -10V	-	30.5	-	nC
Gate-Source Charge	Q _{gs}		-	5.2	-	
Gate-Drain Charge	Q _{gd}		-	7.0	-	
Input Capacitance	C _{iss}	V _{DS} = -15V, V _{GS} = 0V, f = 1.0MHz	-	1433	-	pF
Reverse Transfer Capacitance	C _{rss}		-	212	-	
Output Capacitance	C _{oss}		-	338	-	
Turn-On Delay Time	t _{d(on)}	V _{GS} = -10V, V _{DS} = -15V, R _L = 1.25Ω, R _{GEN} = 3Ω	-	15.2	-	ns
Turn-On Rise Time	t _r		-	12.9	-	
Turn-Off Delay Time	t _{d(off)}		-	50.6	-	
Turn-Off Fall Time	t _f		-	34.6	-	
Drain-Source Body Diode Characteristics						
Source-Drain Diode Forward Voltage	V _{SD}	I _S = -1A, V _{GS} = 0V	-	-0.71	-1.0	V
Body Diode Reverse Recovery Time	t _{rr}	I _F = -12A, di/dt = 100A/μs	-	38.5		ns
Body Diode Reverse Recovery Charge	Q _{rr}		-	35.9	-	nC

Note :

1. Surface mounted FR-4 board by JEDEC (jesd51-7)
2. Starting T_J=25°C, L=1mH, I_{AS}= -13A V_{DD}=-20V, V_{GS}=-10V.
3. T < 10sec

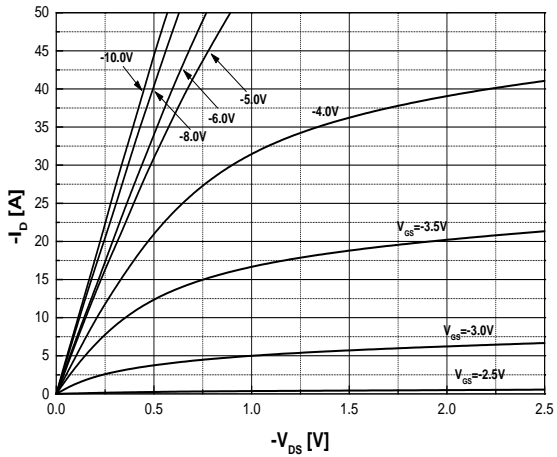

Fig.1 On-Region Characteristics

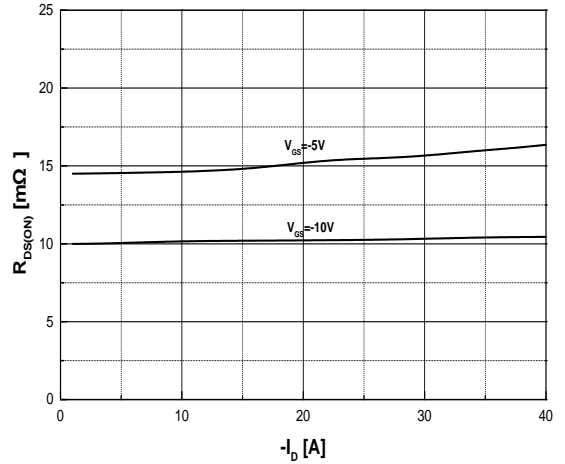

Fig.2 On-Resistance Variation with Drain Current and Gate Voltage

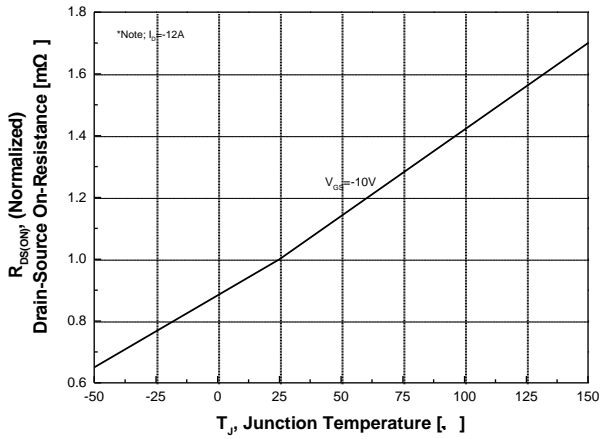

Fig.3 On-Resistance Variation with Temperature

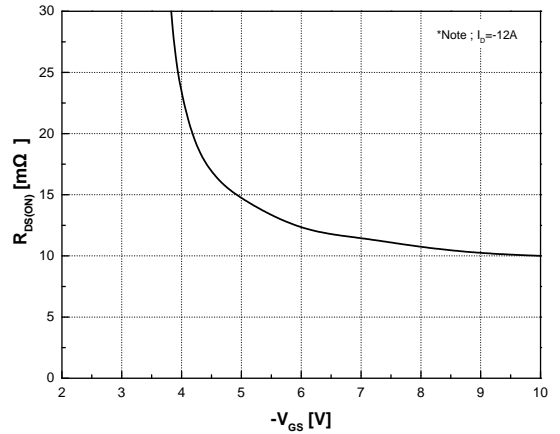

Fig.4 On-Resistance Variation with Gate to Source Voltage

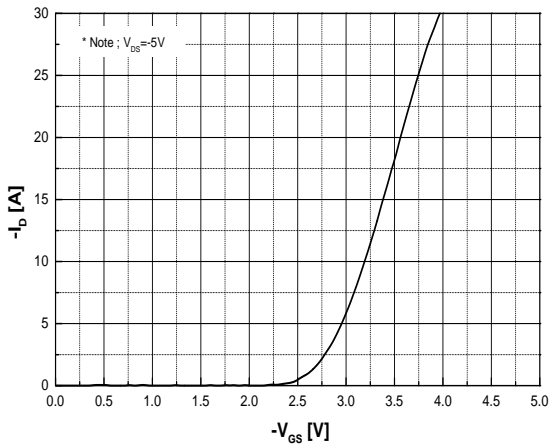

Fig.5 Transfer Characteristics

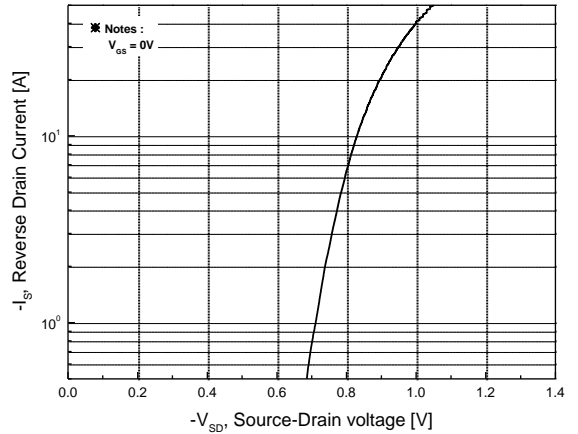

Fig.6 Body Diode Forward Voltage Variation with Source Current and Temperature

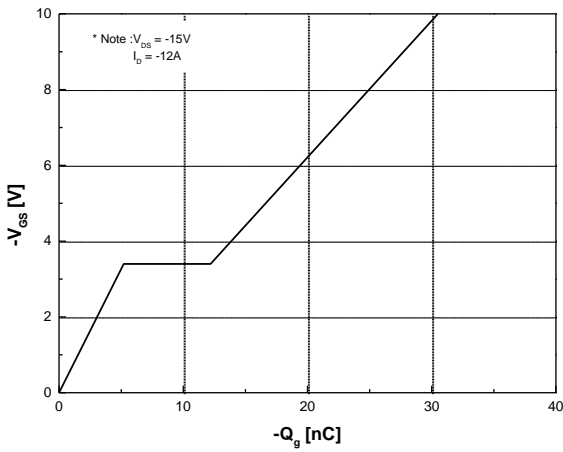

Fig.7 Gate Charge Characteristics

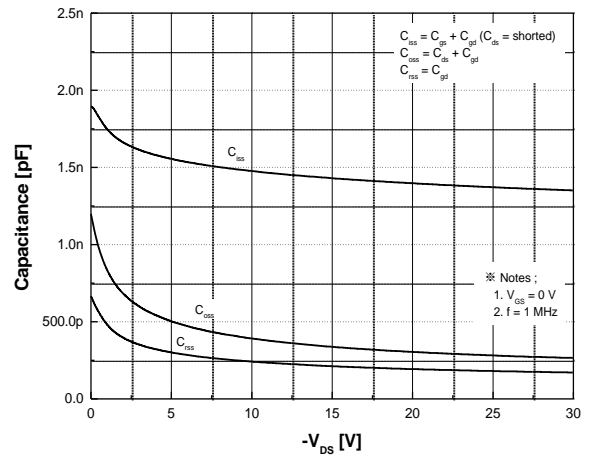

Fig.8 Capacitance Characteristics

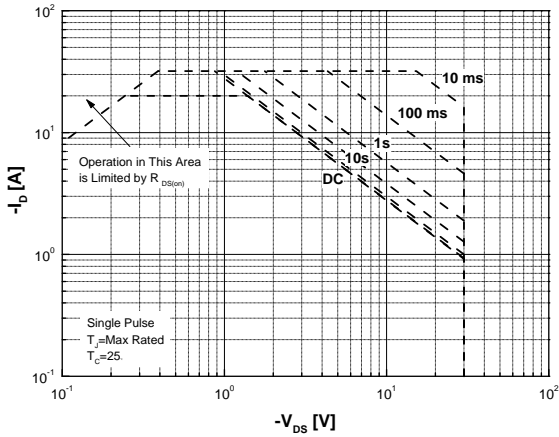

Fig.9 Maximum Safe Operating Area

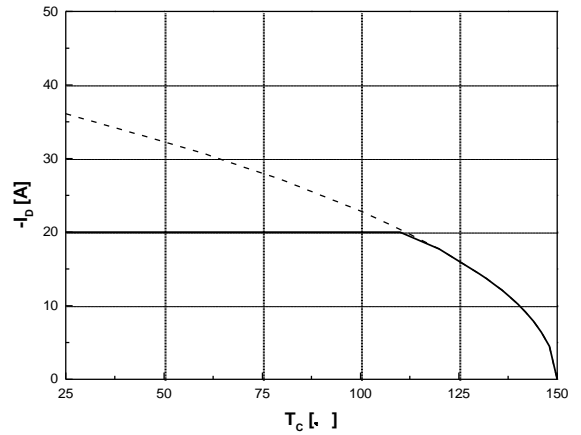

Fig.10 Maximum Drain Current vs. Ambient Temperature (T_c)

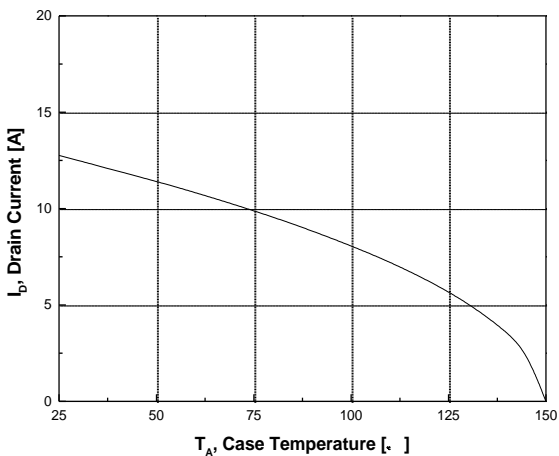

Fig.11 Maximum Drain Current vs. Ambient Temperature (T_A)

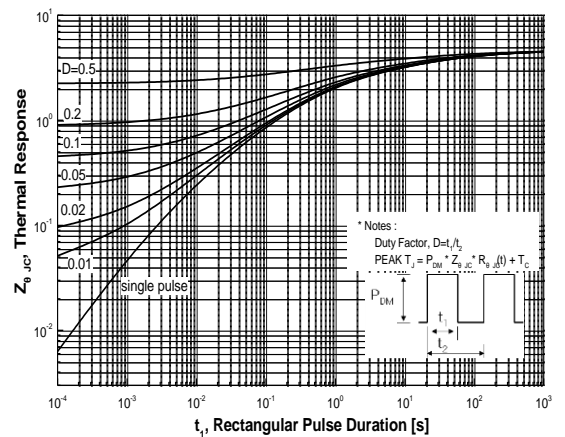
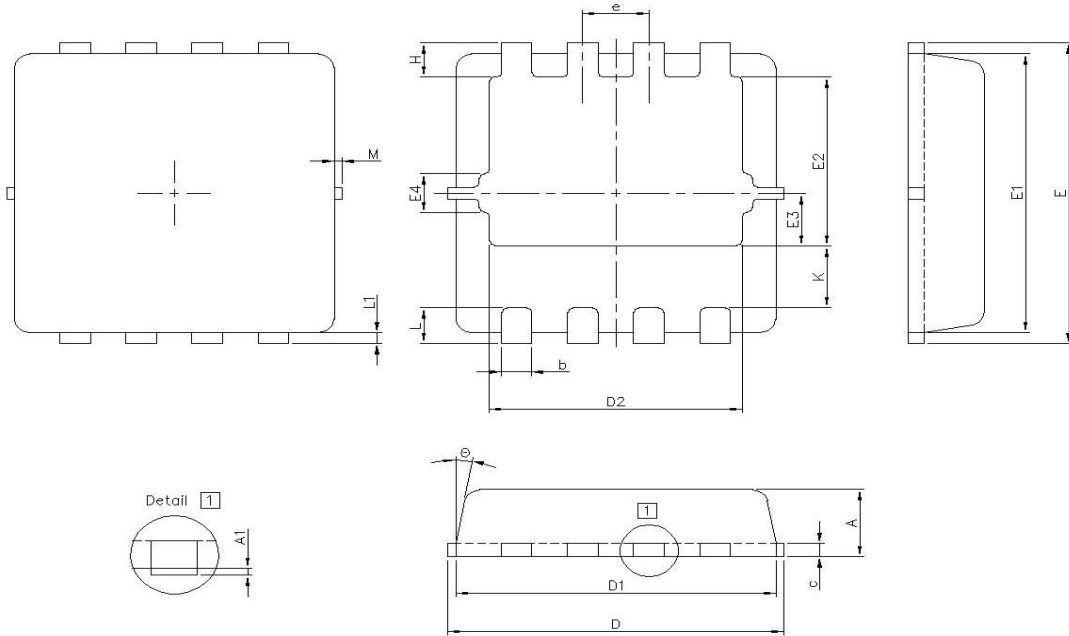

Fig.12 Transient Thermal Response Curve

Package Dimension

PowerDFN33 (3.3x3.3mm)

Dimensions are in millimeters, unless otherwise specified



(Unit: mm)

DIM	Min	Max	DIM	Min	Max
A	0.70	0.80	E2	1.78	1.98
A1	0.00	0.05	E3	0.49	0.69
b	0.25	0.35	E4	0.35 TYP.	
c	0.10	0.25	e	0.65 BSC	
D	3.20	3.40	K	0.70 TYP.	
D1	3.00	3.20	L	0.30	0.50
D2	2.39	2.59	L1	0.13 TYP.	
E	3.25	3.45	H	0.27	0.47
E1	3.00	3.20	Θ	0	12

Land Pattern
(Only for Reference)

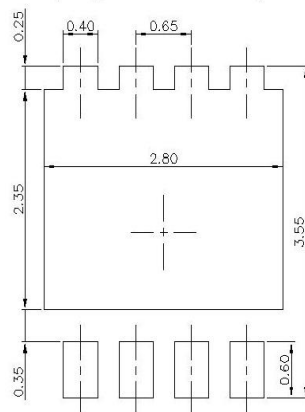

DISCLAIMER:

The Products are not designed for use in hostile environments, including, without limitation, aircraft, nuclear power generation, medical appliances, and devices or systems in which malfunction of any Product can reasonably be expected to result in a personal injury. Seller's customers using or selling Seller's products for use in such applications do so at their own risk and agree to fully defend and indemnify Seller.

MagnaChip reserves the right to change the specifications and circuitry without notice at any time. MagnaChip does not consider responsibility for use of any circuitry other than circuitry entirely included in a MagnaChip product.  is a registered trademark of MagnaChip Semiconductor Ltd.