

SHAFT SHOWN IN FULL C.C.W. POSITION

MOUNTING SURFACE

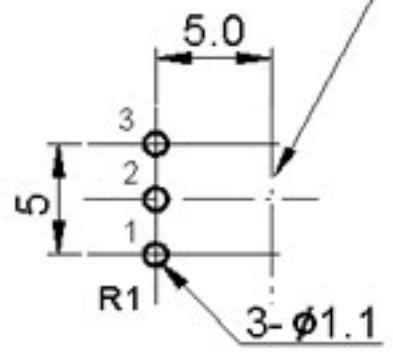

N

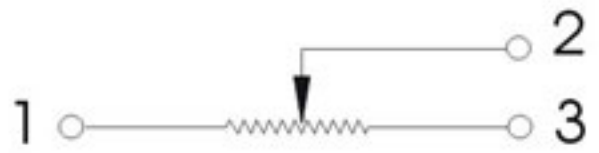

P.C.B. MOUNTING HOLE DETAIL

TAPERS (A) SERIES

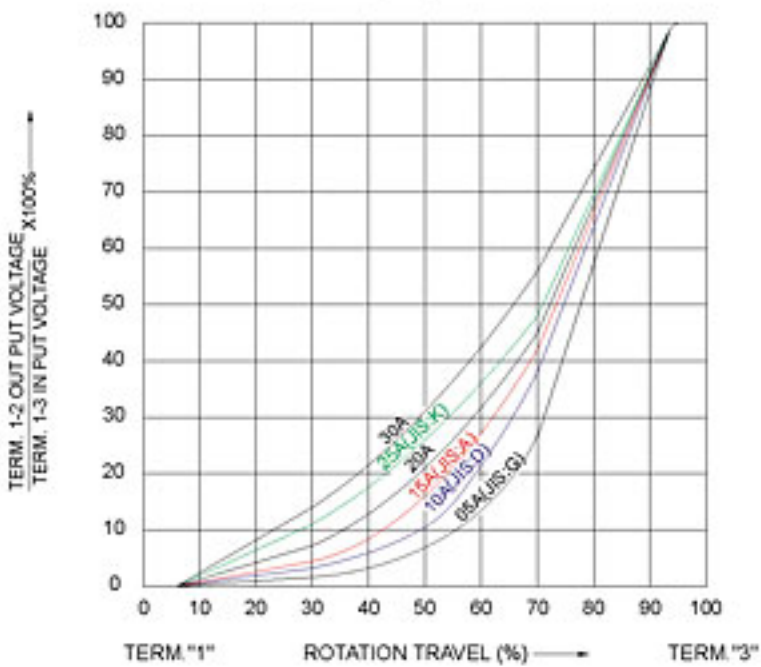

TAPERS (A&C) WITH 50% TAP

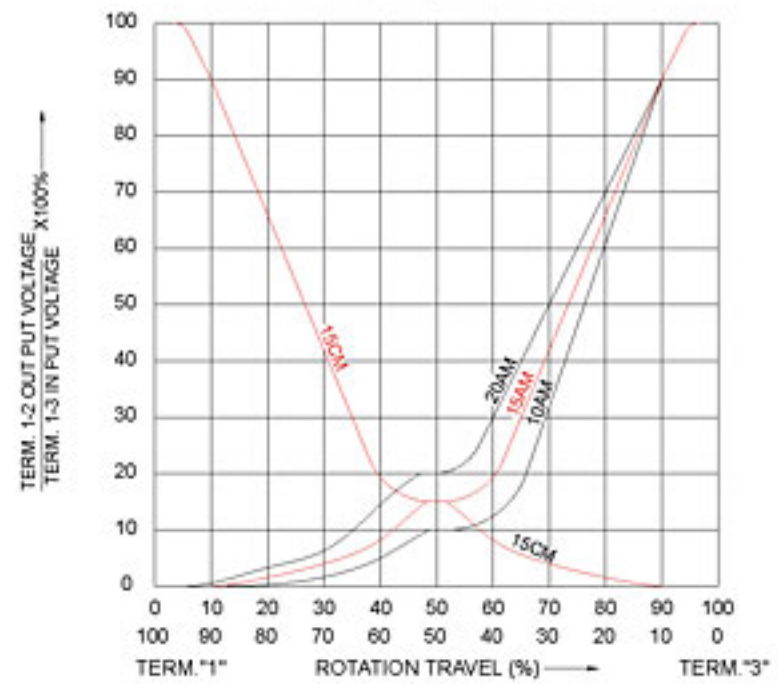

TAPERS (B) SERIES

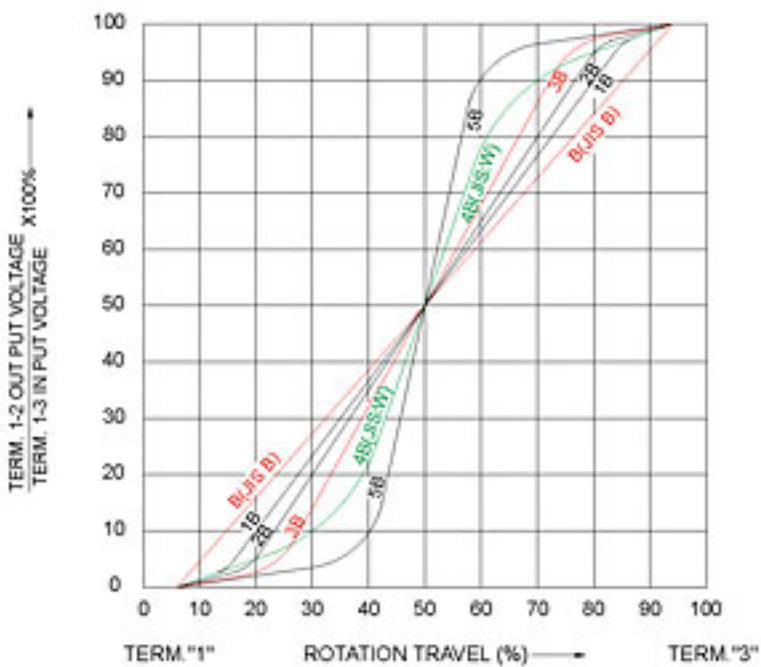

TAPERS (B) WITH 50% TAP

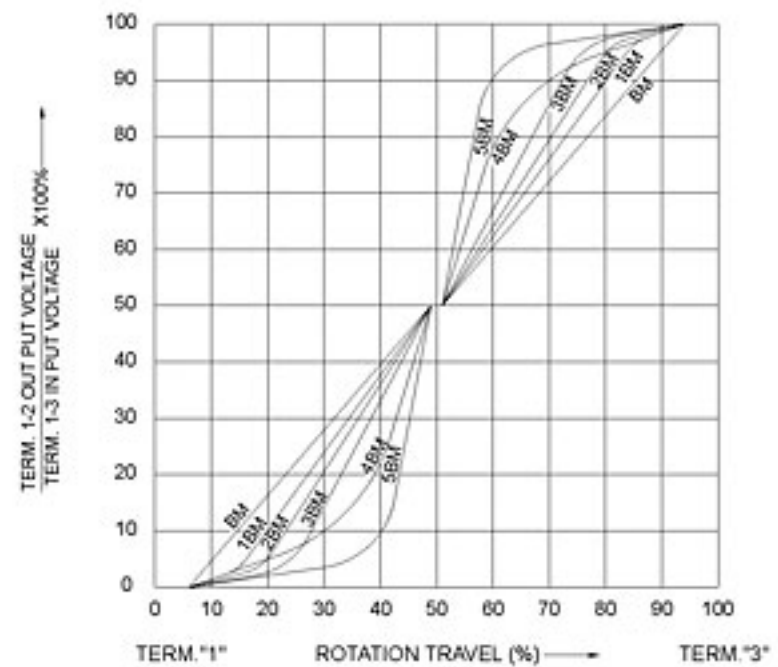

TAPERS (C) SERIES

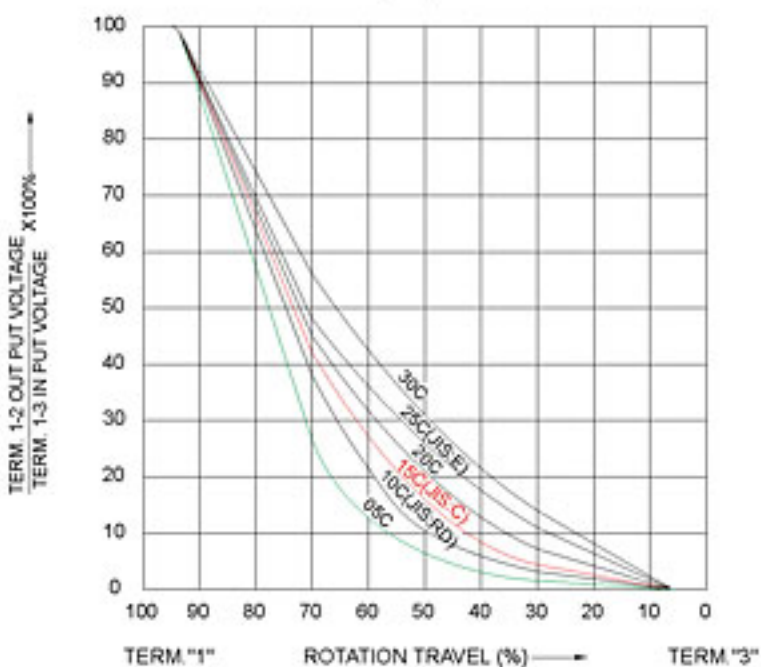

TAPERS (M & N)

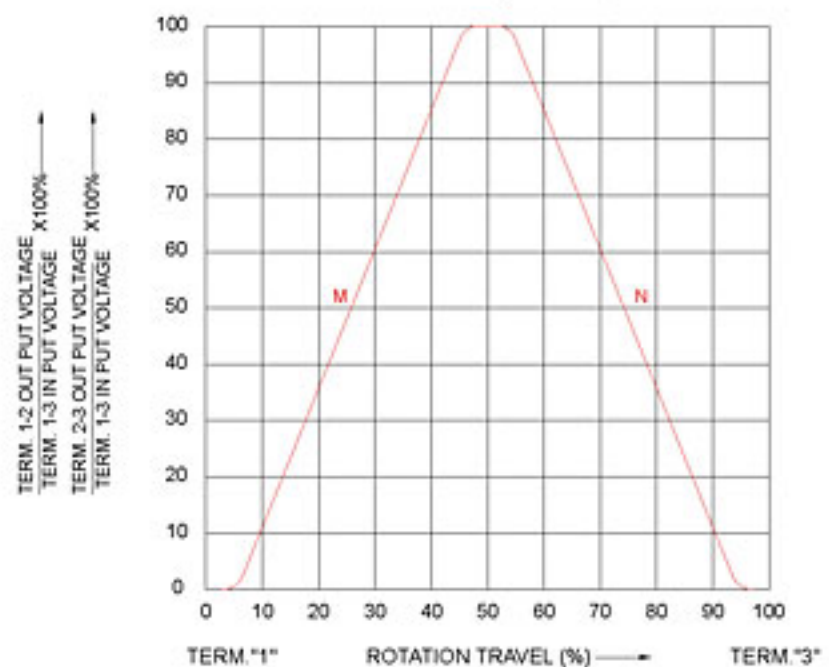

## RD09 系列规格参数 SPECIFICATIONS

## ■ 机械特性 MECHANICAL SPECIFICATION

|                              |   |
|------------------------------|---|
| 全旋转角度 Total Rotational Angle | $300^{\circ} \pm 10^{\circ}$                |
| 旋转力矩 Rotational Torque       | 20~120gf.cm                                 |
| 定位位置 Click Position          | Center click or 41 click                    |
| 定位推动力 Click Slip Out Force   | 30~150gf.cm                                 |
| 开关工作角度 Switch Working Angle  | $\leq 50^{\circ}$ (rotary power switch)     |
| 开关工作动力 Switch Working Torque | $\leq 1\text{kgf.cm}$ (rotary power switch) |
| 止档强度 Shaft Stop Strength     | $\leq 4\text{kgf.cm}$                       |
| 轴推拉强度 Push & Pull Strength   | $\geq 8\text{kgf.cm}$                       |

## ■ 电气特性 ELECTRICAL SPECIFICATION

|                                  |   |
|----------------------------------|---|
| 总阻及误差 Total Resistance Range     | $1\text{K}\Omega < R < 1\text{M}\Omega \pm 20\%$ , $1\text{K}\Omega \geq R \geq 1\text{M}\Omega \pm 30\%$ |
| 电阻特性曲线 Resistance Taper          | Refer to P. 58  |
| 负载功率 Power Rating                | $\leq 0.05\text{W}$   |
| 最大工作电压 Max. Operating Voltage    | 50V AC  |
| 残留电阻 Residual Resistance         | $R_{1-2}$ Less than $10\Omega$ ; $R_{2-3}$ Less than $20\Omega$ ;   |
| 旋转杂音 Rotational Noise            | $\leq 100\text{mV}$   |
| 同步误差 Tracking Error              | $\leq \pm 3\text{dB}$ at $-40\sim 0\text{dB}$   |
| 开关接触电阻 Switch Contact Resistance | $0.5\Omega$ Less than   |
| 开关承受负载 Switch Power Rating       | 12V DC 1A Max   |
| 绝缘电阻 Insulation Resistance       | $50\text{M}\Omega$ min at 250V DC   |
| 耐电压 Withstanding Voltage         | 1 minute at 250V AC   |

## ■ 耐久性能 ENDURANCE

|                      |                      |
|----------------------|----------------------|
| 旋转寿命 Rotational Life | $\geq 10,000$ cycles |
|----------------------|----------------------|